

18mm Door panel

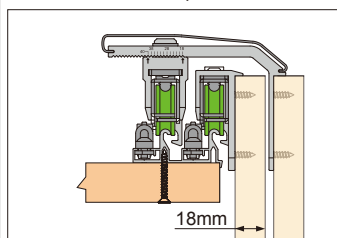

40mm Door panel

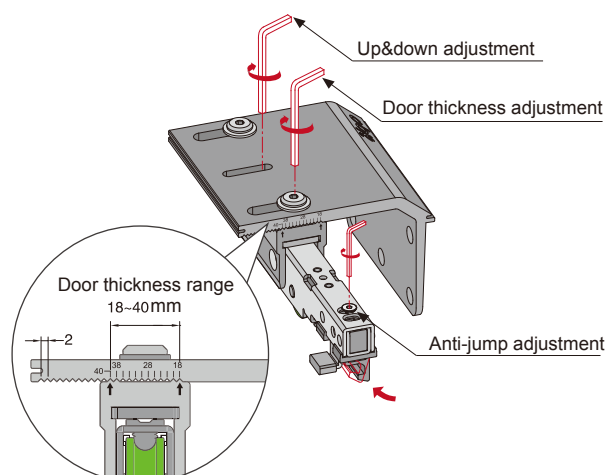
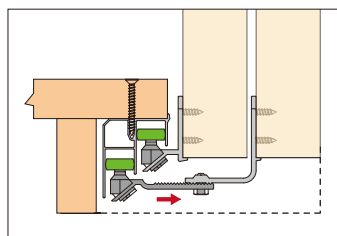
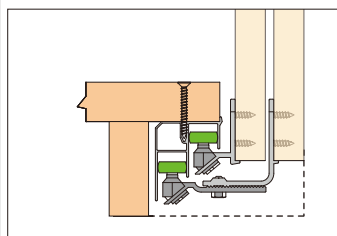
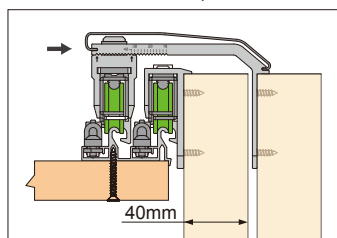

Installation dimensions

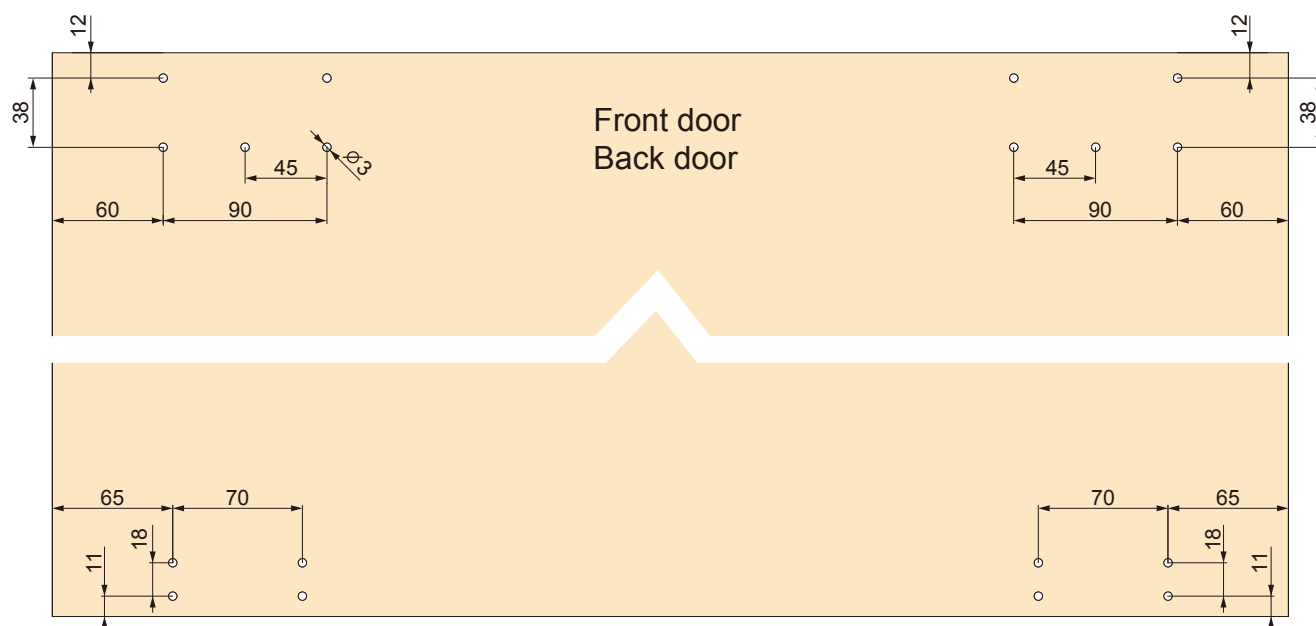

Install front door accessories

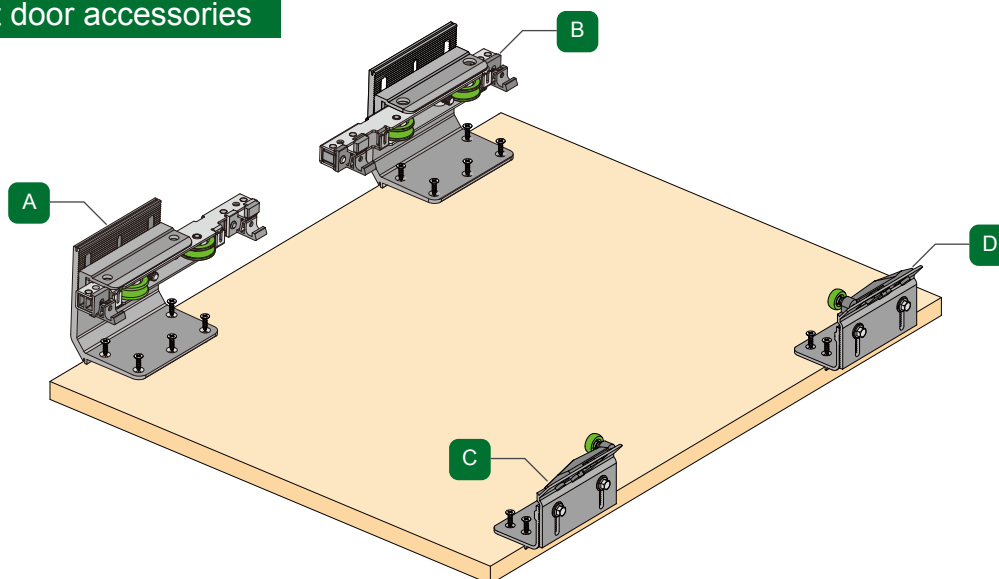

Install back door accessories

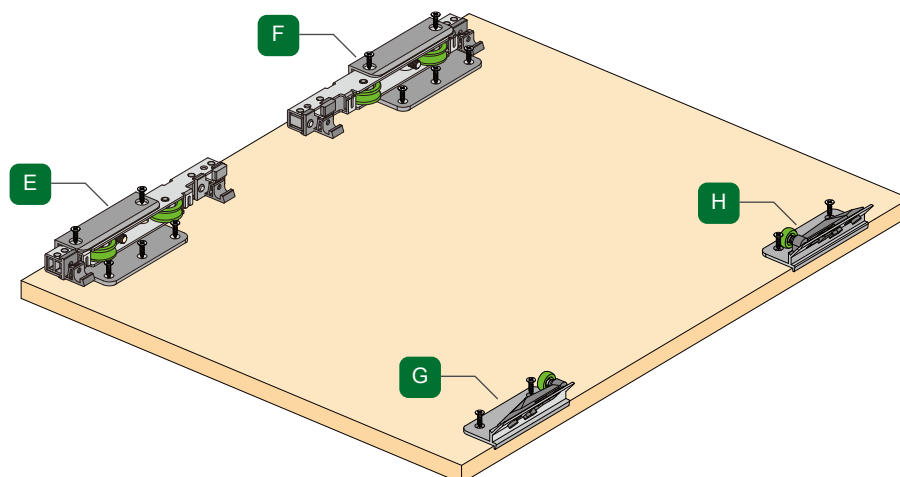

Install front door accessories

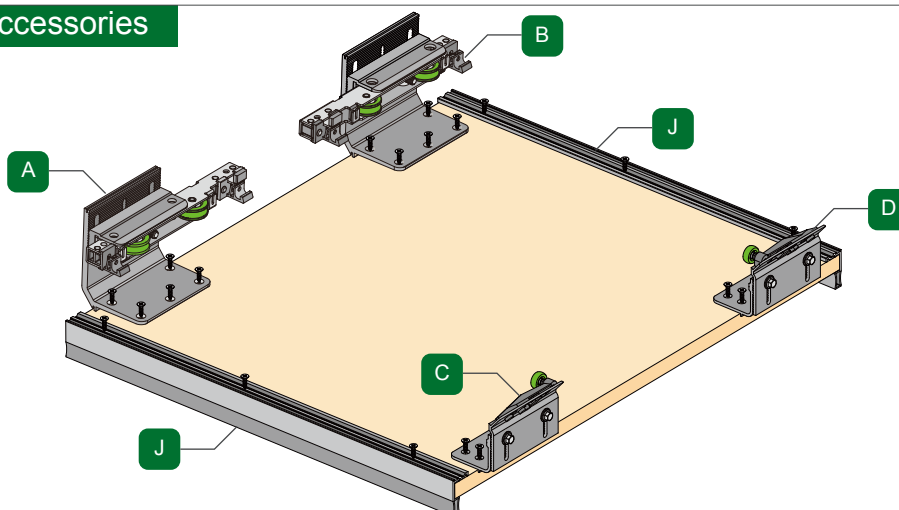

Install back door accessories

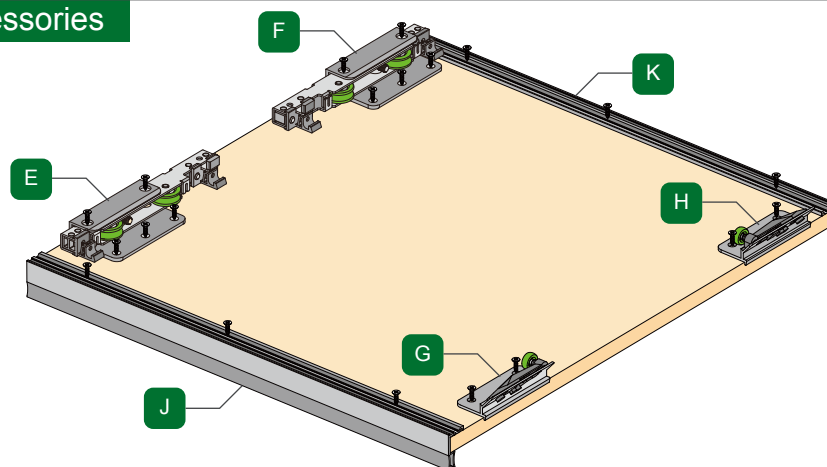

Install top track

Or

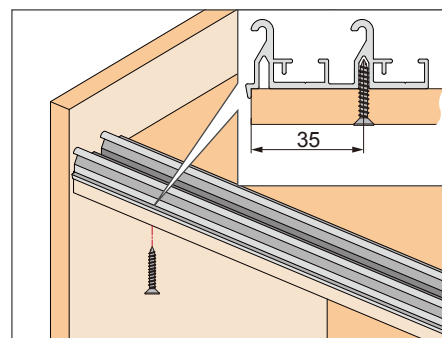
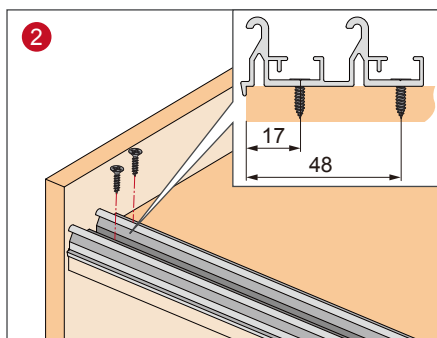
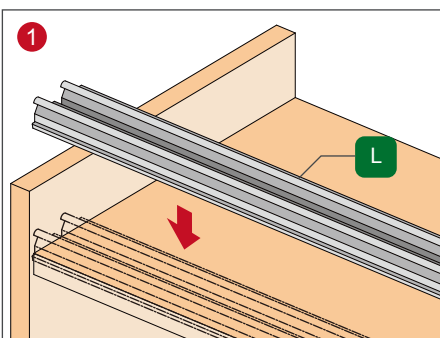

Install bottom track

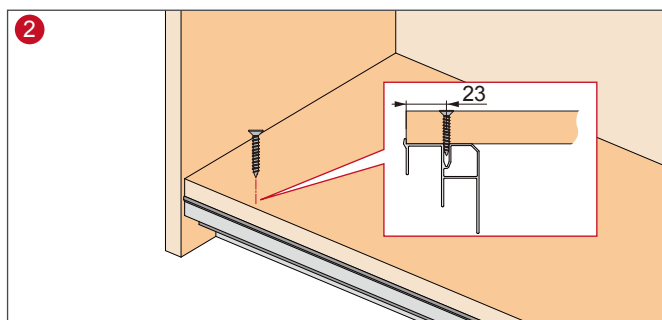
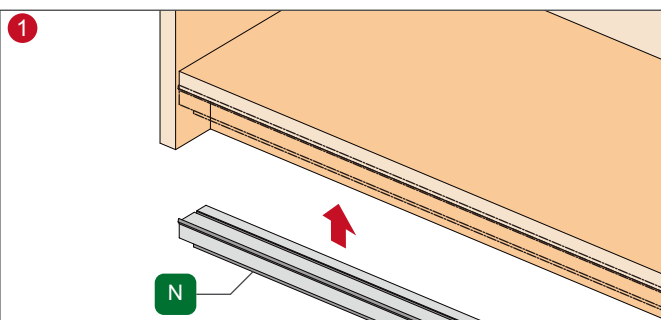

Install back door

1

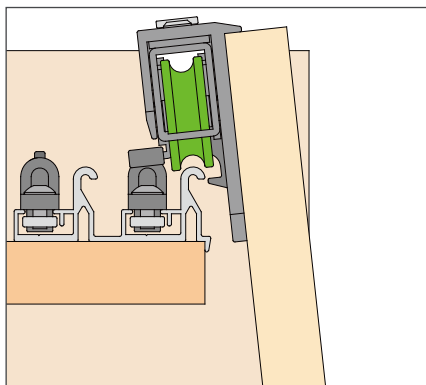

2

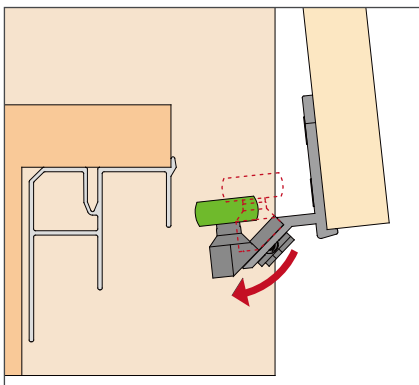

3

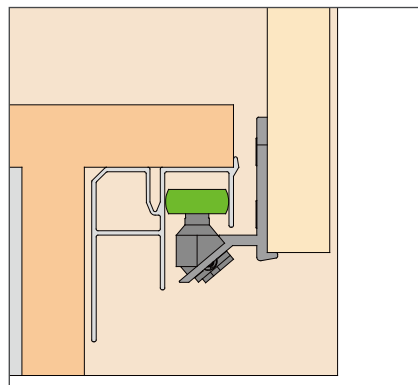

Install front door

1 Loosing top running part

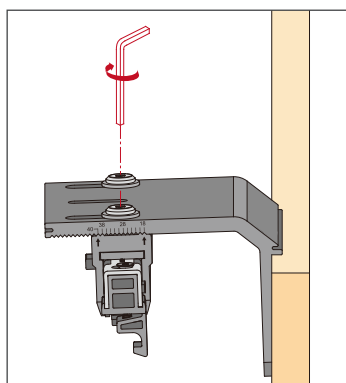

2 Adjustment according to door thickness

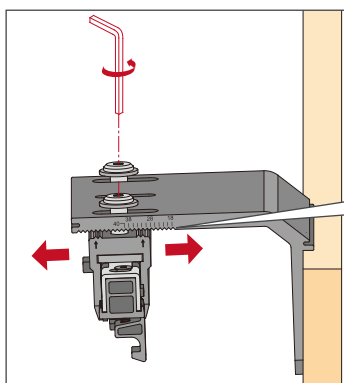

Door thickness:40mm

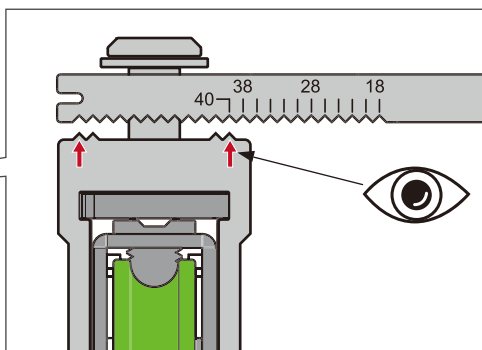

3 Loosing bottom guiding part

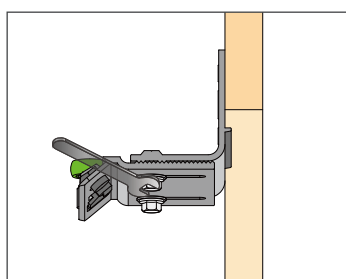

4 Adjustment according to door thickness

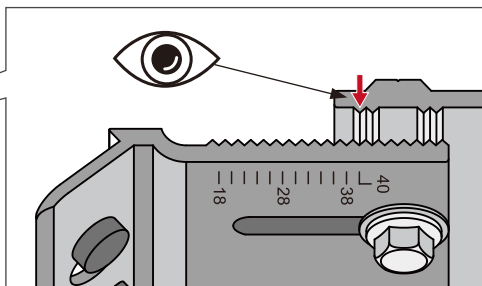
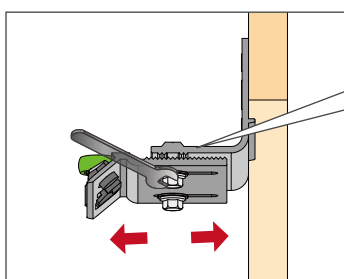

5

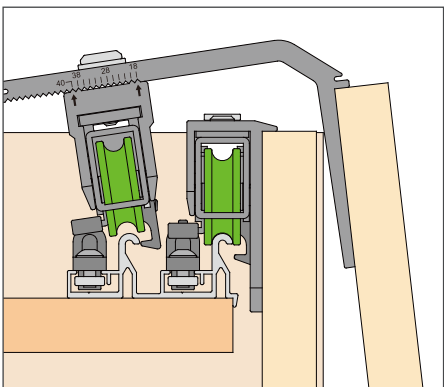

6

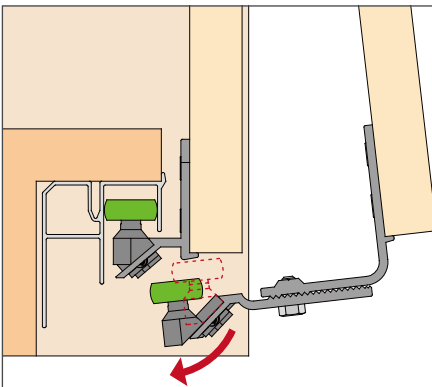

7

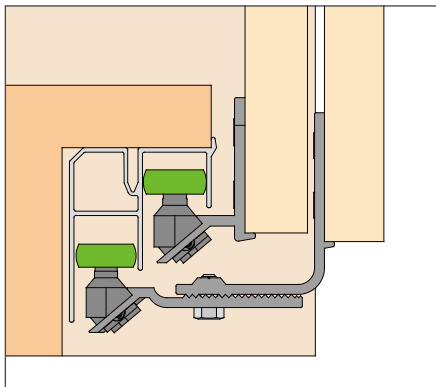

Door height adjustment

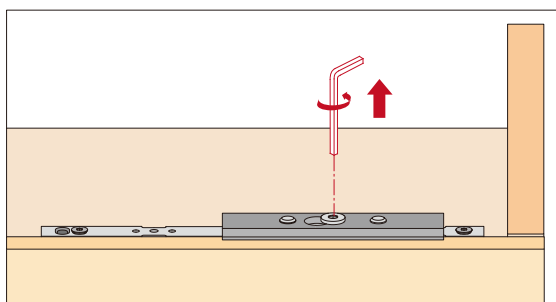
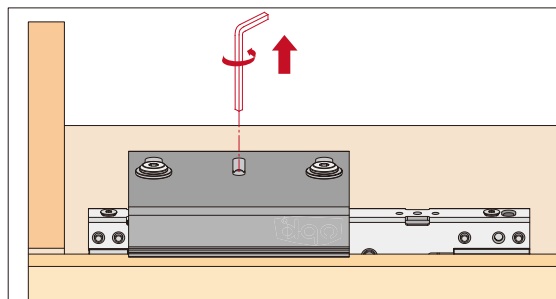
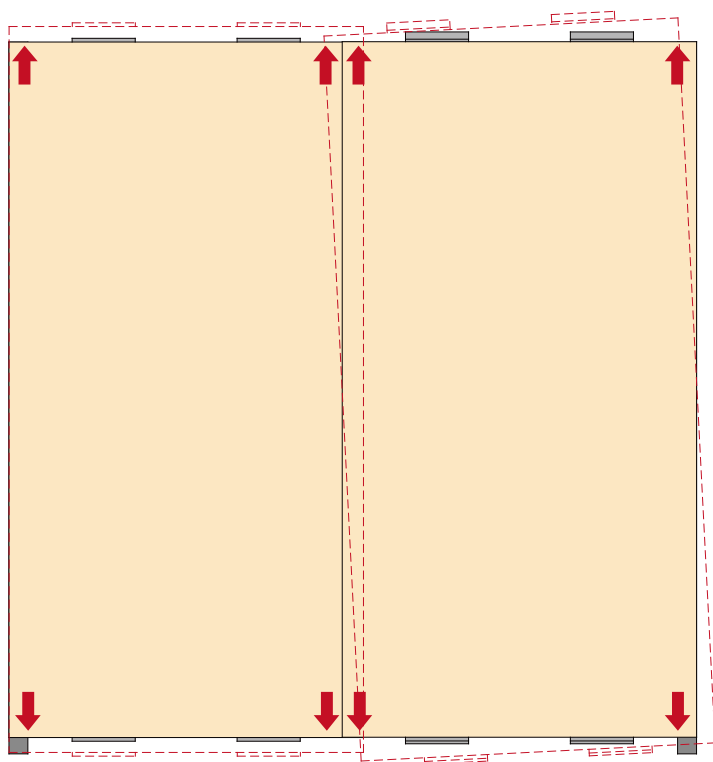

Install damper

1 Open the damper hook

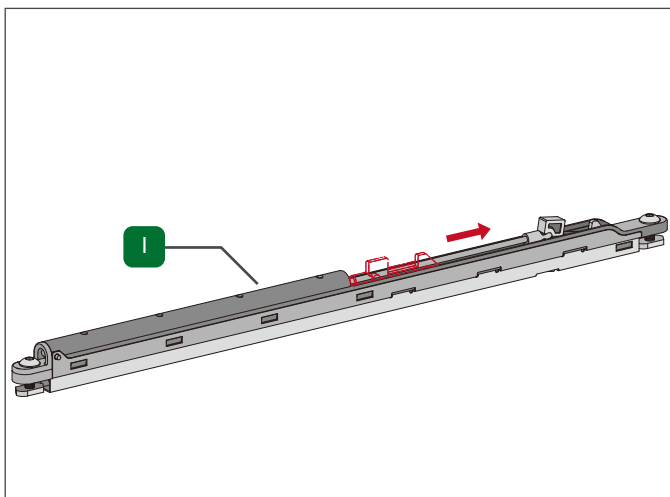

2

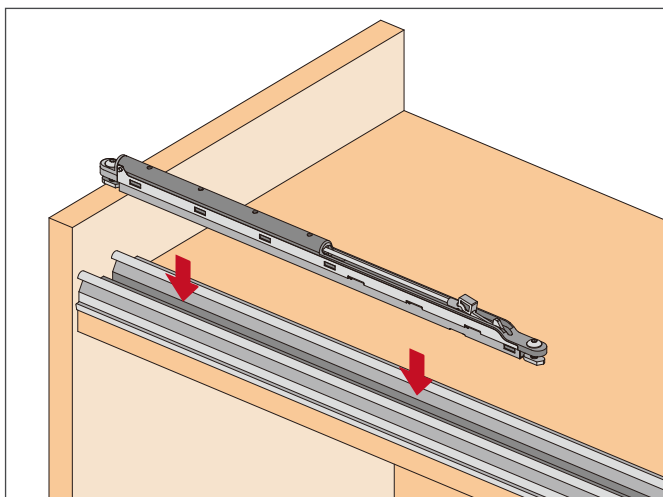

Damper location



Position the damper

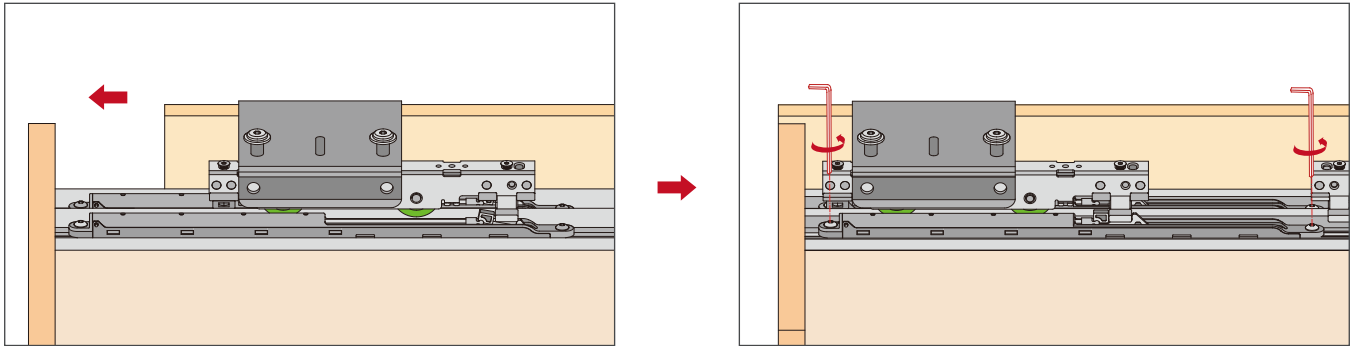

Anti-jump hook adjustment

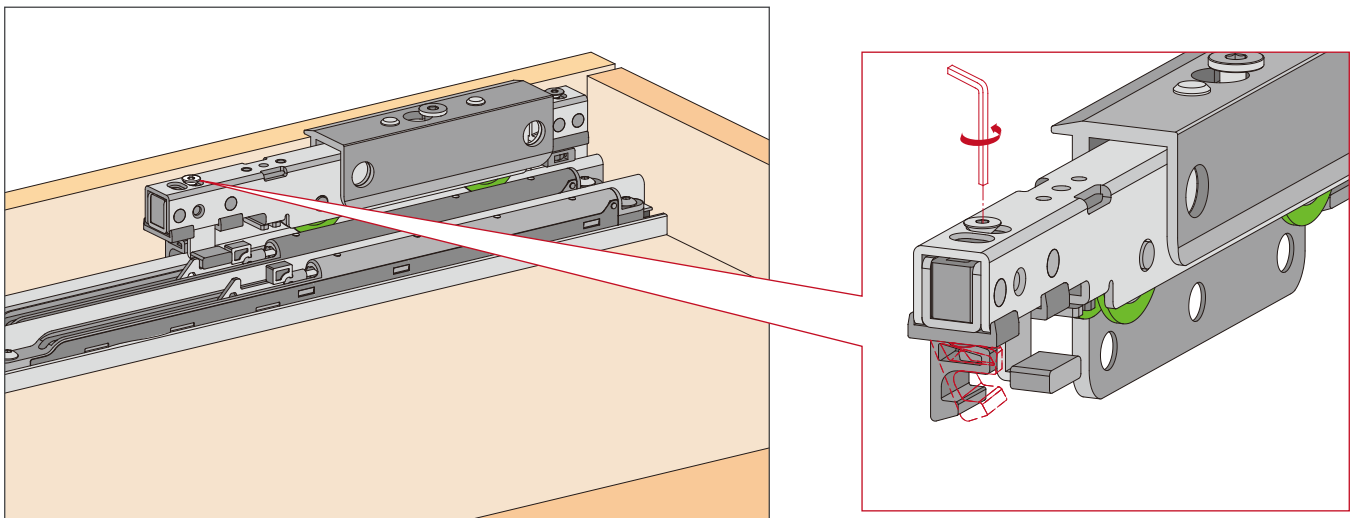

Install decorative cover for outer door (optional)

